



Tabung FRP MITTECH

**image displayed above as reference may differ from actual product requested*

MITRA WATER

CV. Mitra Usaha Mandiri

Water

Treatment

Specialist.

www.supplierfilterair.com

Office :

JL. Pucang Anom no.22,
Pucang Sewu, Gubeng, Surabaya
60282

Phone :

031-9944-9590

MITTECH FRP Tank



MITRA WATER

CV. Mitra Usaha Mandiri

*Water
Treatment
Specialist.*

www.supplierfilterair.com

Office :

JL. Pucang Anom no.22,
Pucang Sewu, Gubeng, Surabaya
60282

Phone :

031-9944-9590



Structure and Material

Formed by winding fiber glasses with high performance resin, ABS liner, FRP liner, fully satisfy customers expectation.

Features

Corrosion resistance, High strength, Easy transportation, Convenient installation.

Operation Condition

Operational pressure: Maximum 150 psi (10 bar)

Operational temperature: 1- 49°C,

Maximum vacuum: 5" Hg (127mm Hg)

Application Field

Feed water and waste water treatment in all industrial, commercial as well as residential fields.

MITRA WATER

CV. Mitra Usaha Mandiri

Water

Treatment

Specialist.

www.supplierfilterair.com

Office :

JL. Pucang Anom no.22,
Pucang Sewu, Gubeng, Surabaya
60282

Phone :

031-9944-9590

ABS Liner with Epoxy Resin Winding (FRP Tank Diameter from 7 inch to 18 inch)

SIZE (inch)	SIZE (mm)	CAPACITY(L)	OPENING (inch)		LA (mm)	LB (mm)	LC (mm)	X (mm)	O.D (mm)
			TOP	BOTTOM					
7X13	φ 180X335	6.3	2.5" NPSM	\	334	320	304	198	181
7X17	φ 180X430	8.6	2.5" NPSM	\	428	414	398	292	181
7X35	φ 180X905	20.1	2.5" NPSM	\	904	890	874	768	181
7X44	φ 180X1130	25.6	2.5" NPSM	\	1132	1118	1102	996	181
8X13	φ 205X335	7.9	2.5" NPSM	\	335	321	305	181	206
8X17	φ 205X445	11.3	2.5" NPSM	\	446	432	416	292	206
8X35	φ 205X905	24.0	2.5" NPSM	\	905	891	875	751	206
8X44	φ 205X1130	32.5	2.5" NPSM	\	1131	1117	1101	977	206
9X17	φ 230X430	13.3	2.5" NPSM	\	427	413	397	256	232
9X35	φ 230X905	32.0	2.5" NPSM	\	905	891	875	734	232
9X42	φ 230X1085	39.0	2.5" NPSM	\	1085	1071	1055	914	232
9X48	φ 230X1230	44.7	2.5" NPSM	\	1232	1218	1202	1061	232
10X17	φ 255X445	17.8	2.5" NPSM	\	447	433	417	259	257
10X35	φ 255X905	38.6	2.5" NPSM	\	903	889	873	715	257
10X44	φ 255X1130	49.5	2.5" NPSM	\	1130	1116	1100	942	257
10X54	φ 255X1390	61.9	2.5" NPSM	\	1390	1376	1360	1202	257
12X48	φ 300X1235	77.3	2.5" NPSM	\	1233	1223	1203	1010	305
12X52	φ 300X1340	84.8	2.5" NPSM	\	1342	1332	1312	1115	305
12X65	φ 300X1650	106.3	2.5" NPSM	\	1650	1640	1620	1425	305
13X44	φ 330X1140	82.9	2.5" NPSM	\	1142	1132	1112	900	334
13X54	φ 330X1400	103.6	2.5" NPSM	\	1400	1390	1370	1155	334
14X65	φ 355X1670	145.6	2.5" NPSM	\	1671	1661	1641	1410	360
14X65	φ 355X1670	145.6	4" -8UN	\	1670	1661	1641	1410	360
16X65	φ 400X1670	187.7	2.5" NPSM	\	1672	1662	1642	1380	410
16X65	φ 400X1670	187.7	4" -8UN	\	1671	1662	1642	1380	410
18X65	φ 450X1670	237.0	4" -8UN	\	1670	1640	1612	1310	465

MITRA WATER

CV. Mitra Usaha Mandiri

Water

Treatment

Specialist.

www.supplierfilterair.com

Office :

JL. Pucang Anom no.22,
Pucang Sewu, Gubeng, Surabaya
60282

Phone :

031-9944-9590

FRP Liner (FRP Tank Diameter from 20 inch to 70 inch)

SIZE (inch)	SIZE (mm)	CAPACITY(L)	OPENING (inch)		LA (mm)	LB (mm)	LC (mm)	X (mm)	O.D (mm)
			TOP	BOTTOM					
20X69	φ 500X1750	305	4" -8UN	\	1750	1720	1685	1360	510
20X69	φ 500X1750	277	4" -8UN	4" -8UN	1750	1580	1545	1220	510
24X72	φ 600X1850	441	4" -8UN	\	1850	1750	1715	1330	612
24X72	φ 600X1850	421	4" -8UN	4" -8UN	1850	1680	1645	1260	612
24X77	φ 600X1950	469	4" -8UN	\	1950	1850	1815	1430	612
24X87	φ 600X2200	520	4" -8UN	6" -8UN	2200	2030	1995	1610	612
30X72	φ 750X1850	676	6" -8UN	\	1850	1750	1715	1240	765
30X72	φ 750X1850	640	4" -8UN	4" -8UN	1850	1670	1635	1160	765
30X77	φ 750X1950	720	6" -8UN	\	1950	1850	1815	1340	765
30X87	φ 750X2200	790	4" -8UN	6" -8UN	2200	2010	1975	1500	765
36X72	φ 900X1850	857	4" -8UN	4" -8UN	1850	1600	1554	1000	918
36X94	φ 900X2400	1207	6" -8UN	\	2400	2150	2104	1550	918
36X94	φ 900X2400	1093	FLANGE	FLANGE	2400	2150	2044	1370	918
40X72	φ 1000X1850	1046	4" -8UN	4" -8UN	1850	1605	1559	945	1020
40X94	φ 1000X2400	1478	6" -8UN	\	2400	2155	2109	1495	1020
40X94	φ 1000X2400	1332	FLANGE	FLANGE	2400	2150	2044	1310	1020
48X72	φ 1200X1850	1202	FLANGE	FLANGE	1850	1558	1451	595	1224
48X94	φ 1200X2400	1824	FLANGE	FLANGE	2400	2108	2001	1145	1224
60X83	φ 1500X2100	2158	FLANGE	FLANGE	2100	1780	1670	630	1530
60X94	φ 1500X2400	2688	FLANGE	FLANGE	2400	2080	1970	930	1530
72X94	φ 1800X2400	3561	FLANGE	FLANGE	2400	2020	1908	700	1836

MITRA WATER

CV. Mitra Usaha Mandiri

Water

Treatment

Specialist.

www.supplierfilterair.com

Office :

JL. Pucang Anom no.22,
Pucang Sewu, Gubeng, Surabaya
60282

Phone :

031-9944-9590

- For residential and light commercial water softener / filtration applications.
- These slim-diameter tanks offer unmatched strength and chemical resistance.
- 7 ~ 18" tanks with ABS liner

Tank features:

- Chemical resistance
- Smooth, fiber-free inner surface
- Completely rust and corrosion free
- Excellent resistance to impact and abrasion
- Light weight, easy for transportation and installation

No	Spec.		vol.(L)	Opening		LA mm	LB mm	LC mm	X mm	O.D mm
	Inch	mm		T	B					
1	7x13	ø180x335	6.3	2.5"NPSM	\	334	320	304	198	181
2	7x17	ø180x430	8.6	2.5"NPSM	\	428	414	398	292	181
3	7x35	ø180x905	20.1	2.5"NPSM	\	904	890	874	768	181
4	7x44	ø180x1130	25.6	2.5"NPSM	\	1132	1118	1102	996	181
5	8x13	ø205x335	7.9	2.5"NPSM	\	335	321	305	181	206
6	8x17	ø205x445	11.3	2.5"NPSM	\	446	432	416	292	206
7	8x35	ø205x905	24.0	2.5"NPSM	\	905	891	875	751	206
8	8x44	ø205x1130	32.5	2.5"NPSM	\	1131	1117	1101	977	206
9	9x17	ø230x430	13.3	2.5"NPSM	\	427	413	397	256	232
10	9x35	ø230x905	32.0	2.5"NPSM	\	905	891	875	734	232
11	9x42	ø230x1085	39.0	2.5"NPSM	\	1085	1071	1055	914	232
12	9x48	ø230x1230	44.7	2.5"NPSM	\	1232	1218	1202	1061	232
13	10x17	ø255x445	17.8	2.5"NPSM	\	447	433	417	259	257
14	10x35	ø255x905	38.6	2.5"NPSM	\	903	889	873	715	257
15	10x44	ø255x1130	49.5	2.5"NPSM	\	1130	1116	1100	942	257
16	10x54	ø255x1390	61.9	2.5"NPSM	\	1390	1376	1360	1202	257
17	12x48	ø300x1235	77.3	2.5"NPSM	\	1233	1223	1203	1010	305
18	12x52	ø300x1340	84.8	2.5"NPSM	\	1342	1332	1312	1115	305
19	12x65	ø300x1650	106.3	2.5"NPSM	\	1650	1640	1620	1425	305
20	13x44	ø330x1140	82.9	2.5"NPSM	\	1142	1132	1112	900	334
21	13x54	ø330x1400	103.6	2.5"NPSM	\	1400	1390	1370	1155	334
22	14x65	ø335x1670	145.6	2.5"NPSM	\	1671	1661	1641	1410	360
23	14x65	ø355x1670	145.6	4"-8UN	\	1670	1661	1641	1410	360
24	16x65	ø400x1670	187.7	2.5"NPSM	\	1672	1662	1642	1380	410
25	16x65	ø400x1670	187.7	4"-8UN	\	1671	1662	1642	1380	410
26	18x65	ø450x1670	237.0	4"-8UN	\	1670	1640	1612	1310	465

Tank material:

- ABS / PE / FRP liner
- Continuous strands of fiberglass with high strength resin.

Operation requirement:

- Operating pressure ≥ 100 psi
- Operating temperature ≥ 120°F
- Vacuum ≤ 127 mmHG (5"Hg)

Tank specification

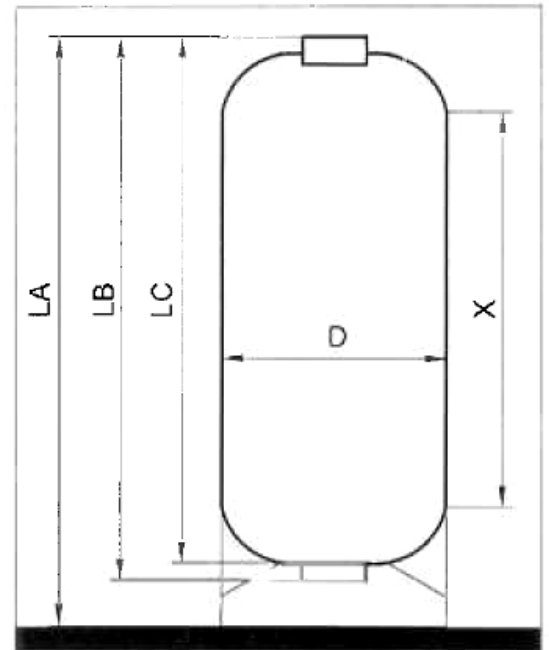

MITRA WATER

CV. Mitra Usaha Mandiri

Water
Treatment
Specialist.

www.supplierfilterair.com

Office :

JL. Pucang Anom no.22,
Pucang Sewu, Gubeng, Surabaya
60282

Phone :

031-9944-9590